

Silensor-sl

Verbinderwechsel • exchange of a connector • changement d'attache
cambio de conector • sostituzione congiuntore • substituição do conector

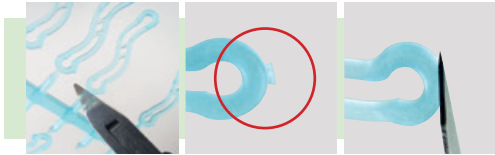

- loser Anker
- loose anchor
- ancre lâche
- ancla suelta
- ancorraggio staccato
- soltar suporte

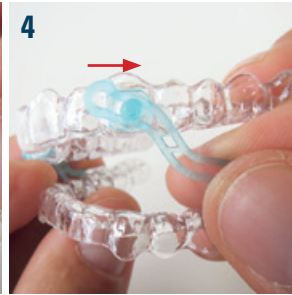
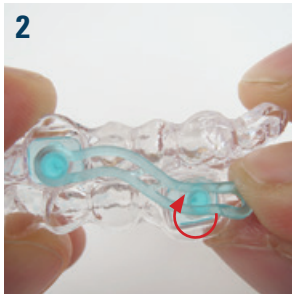
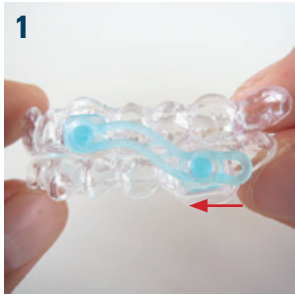
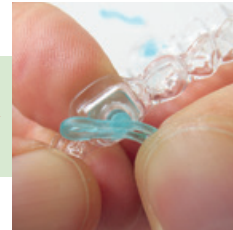

- Anker halten
- hold anchor
- tenir ancre
- mantener ancla
- tenere premuto l'ancoraggio
- segurar suporte

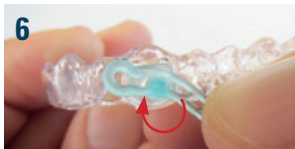

restliche Verbinder hier aufkleben
 glue remaining connectors here
 coller attaches restantes ici
 pegar conectores restantes aquí
 colla premuto l'ancoraggio qui
 colar aqui os restantes conectores

zuerst verwendeter Verbinder
 first used connector
 attache en premier utilisée
 conector utilizó por primera vez
 congiuntore prima utilizzazione
 conector a utilizar na primeira vez

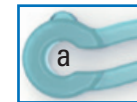
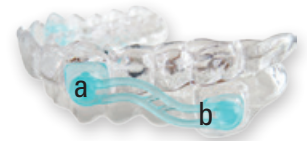
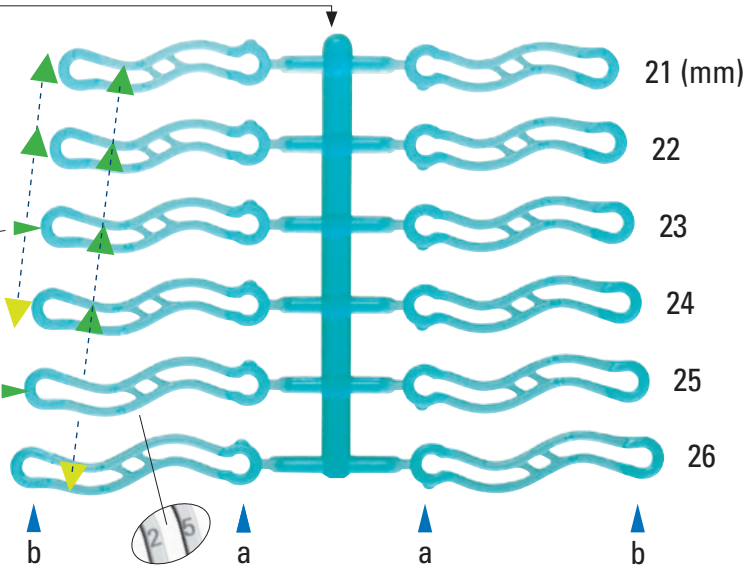

oberer Eckzahn
 upper canine
 canine supérieure
 canino superior
 canino superiore
 canino superior

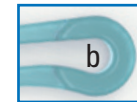

unterer Molarenbereich
 lower molar area
 région molaire inférieure
 zona de molares inferior
 zona dei molari inferiori
 zona do molar inferior

